

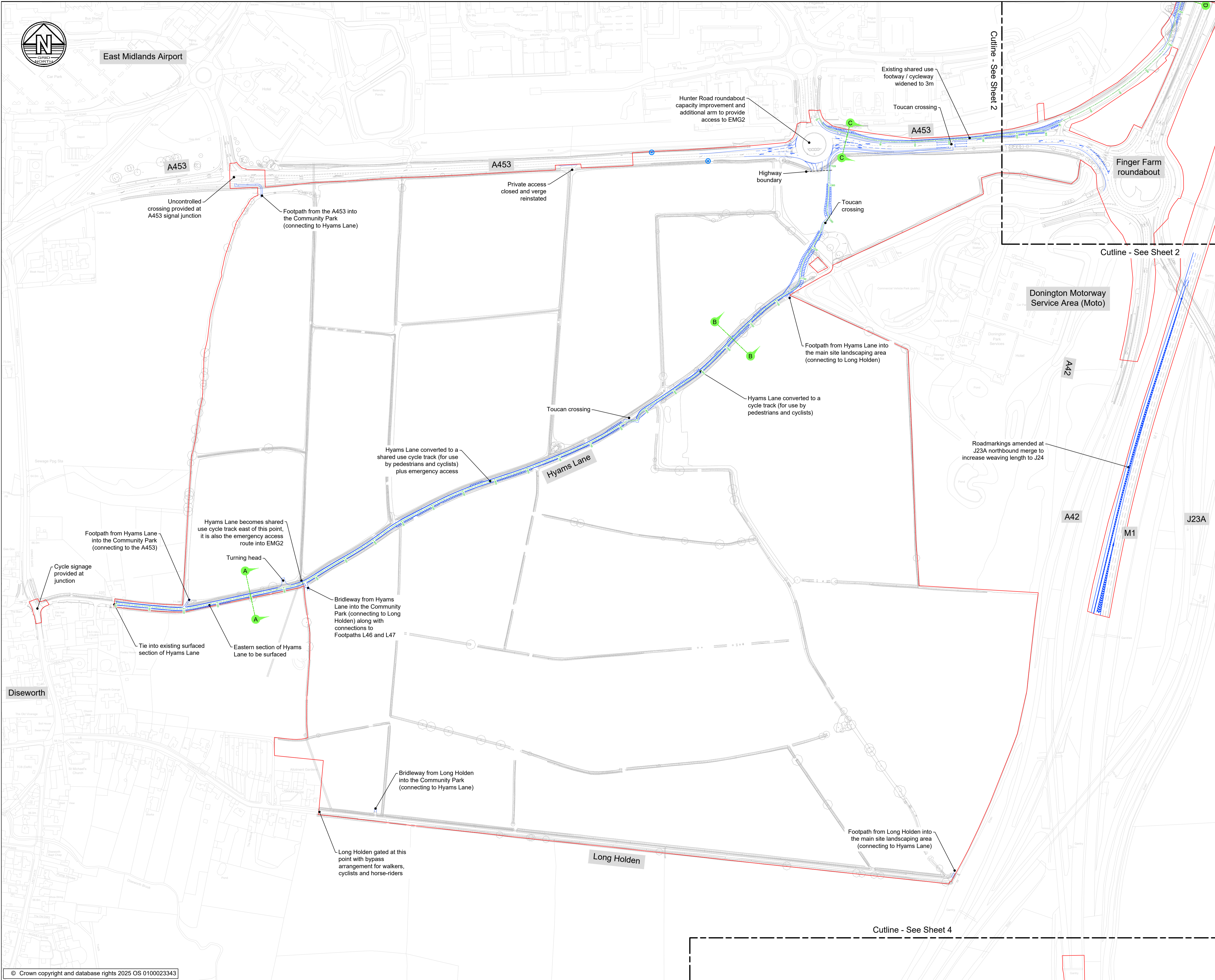

East Midlands Airport



- Notes**
- All dimensions in metres unless noted otherwise.
  - The height of proposed bridges, embankments and depths of cuttings are indicative subject to the limits of deviation referred to in the order.
  - All structure positions and sizes shown are indicative only.
  - The proposed works including their specific alignment will be subject to detailed design within the limits of deviation identified on the works plans.
  - Horizontal and vertical deviation of the highway alignments are permitted in accordance with Article 4 of the Development Consent Order.

**Legend**

- Highway Drainage Outfalls
- Proposed Design
- Draft Order Limits
- Chainage Lines
- Cross section location

0 50 100 150 200  
SCALE: METRES

- Highway Plans Cross Sections**
- Refer to document DCO 2.9A for:
- Hyams Lane (Section A-A, B-B)
  - EMG2 Access (A453) (Section C-C)
- Refer to document DCO 2.9B for:
- Active Travel Link (Section D-D, E-E)
  - M1 Northbound to A50 Westbound Interchange Link (Section F-F)
  - L57 Shared Use Cycle Track (Sections M-M & N-N)
- Refer to document DCO 2.9C for:
- M1 Northbound to A50 Westbound Interchange Link (Section G-G, H-H, I-I)
  - A50 Westbound Interchange Link (Section J-J)
  - A50 Eastbound (Sections K-K & L-L)
- Highway Plans Long Sections**
- Refer to document DCO 2.10A for:
- M1 Northbound to A50 Westbound Interchange Link
  - A50 Westbound Interchange Link
- Refer to document DCO 2.10B for:
- A50 Eastbound to M1 J24 Interchange Link
  - M1 Southbound to M1 J24 Interchange Link
- Refer to document DCO 2.10C for:
- Active Travel Link
  - EMG2 Access
  - L57 Shared Use Cycle Track
- Refer to document DCO 2.10D for:
- Hyams Lane
- A453 Bridge Plan**  
Refer to document DCO 2.11

- Highway Works**
- By reference to the Works Plans (Document 2.3A) and Schedule 1 of the Development Consent Order this plan shows the following highway works:
- Works No. 6;
  - Works No. 7;
  - Works No. 8 (part);
  - Works No. 14 (part);
  - Works No. 15; and
  - Works No. 17.

P11	27.03.26	Updates following RSA 1	DF	SRH
P10	02.02.26	Annotations updated	DF	SRH
P09	21.01.26	Chainage colours updated	DF	SRH
P08	08.10.25	Notes amended	SRH	SRH
P07	31.07.25	Issued for DCO Submission	JFP	SRH
P06	27.06.25	Cross section locations and references added	MS	SRH
P05	16.06.25	Hyams Ln, M1 NB merge & A453 works updates	MS	SRH
P04	28.01.25	Legend & notes updated	MS	SRH
P03	16.01.25	Minor highway revisions	MS	SRH
P02	20.12.24	Dwg frame update, minor highway revisions	MS	SRH
Rev	Date	Details of issue / revision	Drw	Rev



**THE EAST MIDLANDS GATEWAY PHASE 2 AND HIGHWAY ORDER 202[ ]**

Drawing Title  
**HIGHWAY PLANS GENERAL ARRANGEMENT SHEET 1 OF 4**

Scale	1:2500	Drawn	M.S
Size	A1	Reviewed	S.H
Regulation	<b>6(2)</b>	Document	<b>DCO 2.8A</b>

Drawing Status  
**DCO SUBMISSION**

Drawing No.	<b>EMG2-BWB-HGN-XX-DR-H-0101</b>	Revision	<b>P11</b>
-------------	----------------------------------	----------	------------